

KEY TO MATERIALS :-	
1	Visqueen High Performance DPM on smooth floor system.
2	Visqueen CD 150mm Corner Strip.
3	Visqueen V8 Wall Membrane on Anti Lime Coating on smooth concrete wall.
4	Visqueen Axiom UniSeal (2.5mm thick) on smooth concrete channel by others.
5	Visqueen Zedex CPT DPC.
6	External drainage system to be agreed.

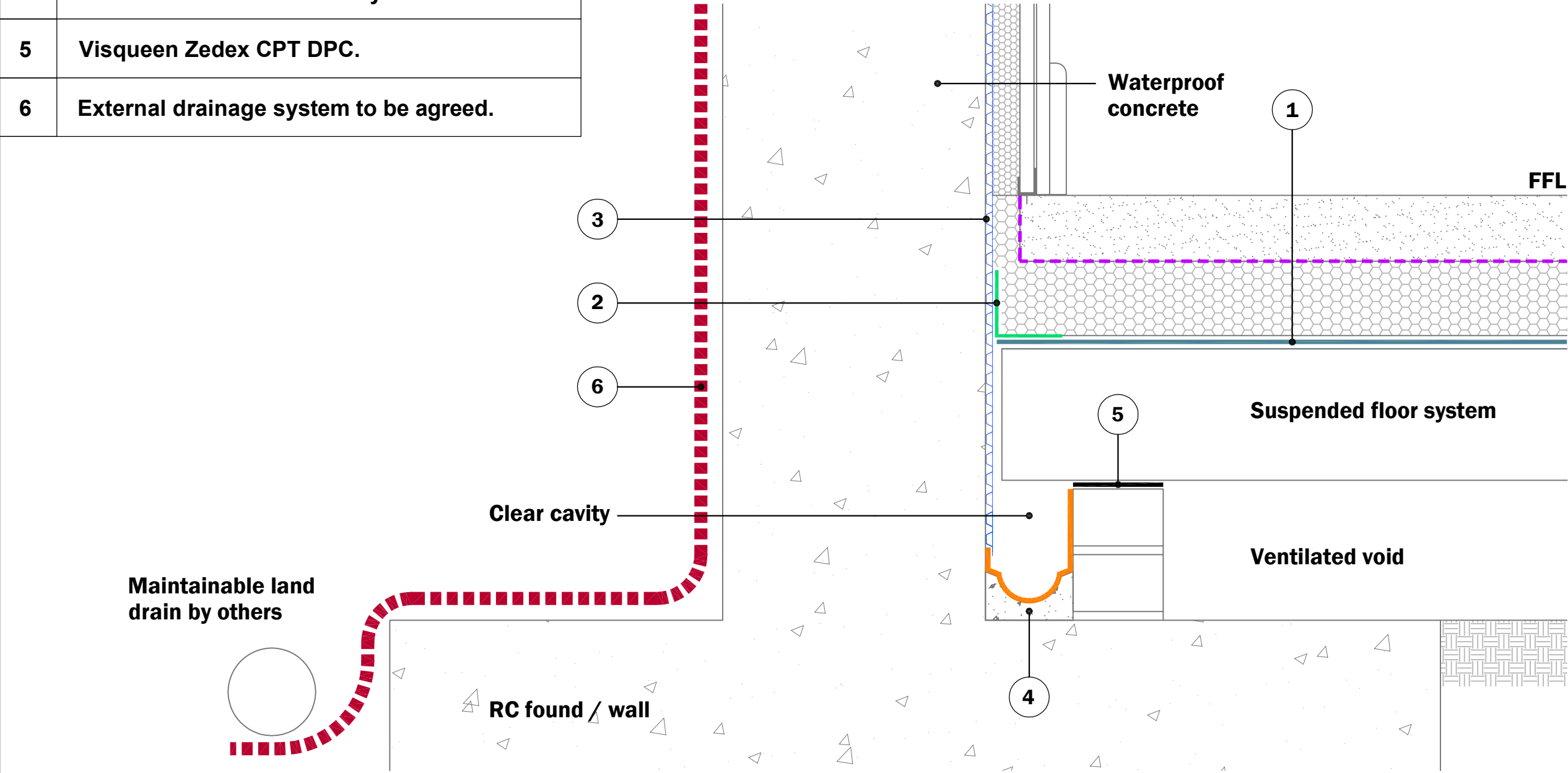

© Copyright reserved. This drawing may not be reproduced or amended without prior written permission.

Detail issued for Guidance Only. Designer's Approval Required.

Site construction sequencing should be assessed before the appropriate Visqueen Standard Detail is selected & approved by the Designer.

In order to develop a robust design for protecting a structure against groundwater, a Risk Assessment must be carried out in line with the guidance given in BS8102:2009.

The Designer may need to specify one or a combination of waterproofing measures.

All Visqueen materials must be installed in strict accordance with the manufacturer's instructions. Refer to the current Visqueen datasheets.

Do Not Scale - Use Figured Dimensions Only.

Detail is subject to SE approval.

## Standard Detail



[www.visqueen.com](http://www.visqueen.com)

Scale : NTS

Date : April.2020

Drawing No : AX-21



## Typical Concrete Drainage Channel Detail.

**VISQUEEN**  
0333 202 6800  
[www.visqueen.com](http://www.visqueen.com)  
[enquiries@visqueen.com](mailto:enquiries@visqueen.com)