

KEY TO MATERIALS :-	
1	Visqueen Pre Applied Membrane on smooth well compacted blinding layer.
2	Visqueen Retaining Discs @ 400mm centres.
3	Visqueen Axiom Guard (2 coats) on Axiom Guard Primer.
4	Visqueen Self Adhesive Membrane (SAM).
5	Visqueen Protect&Drain.

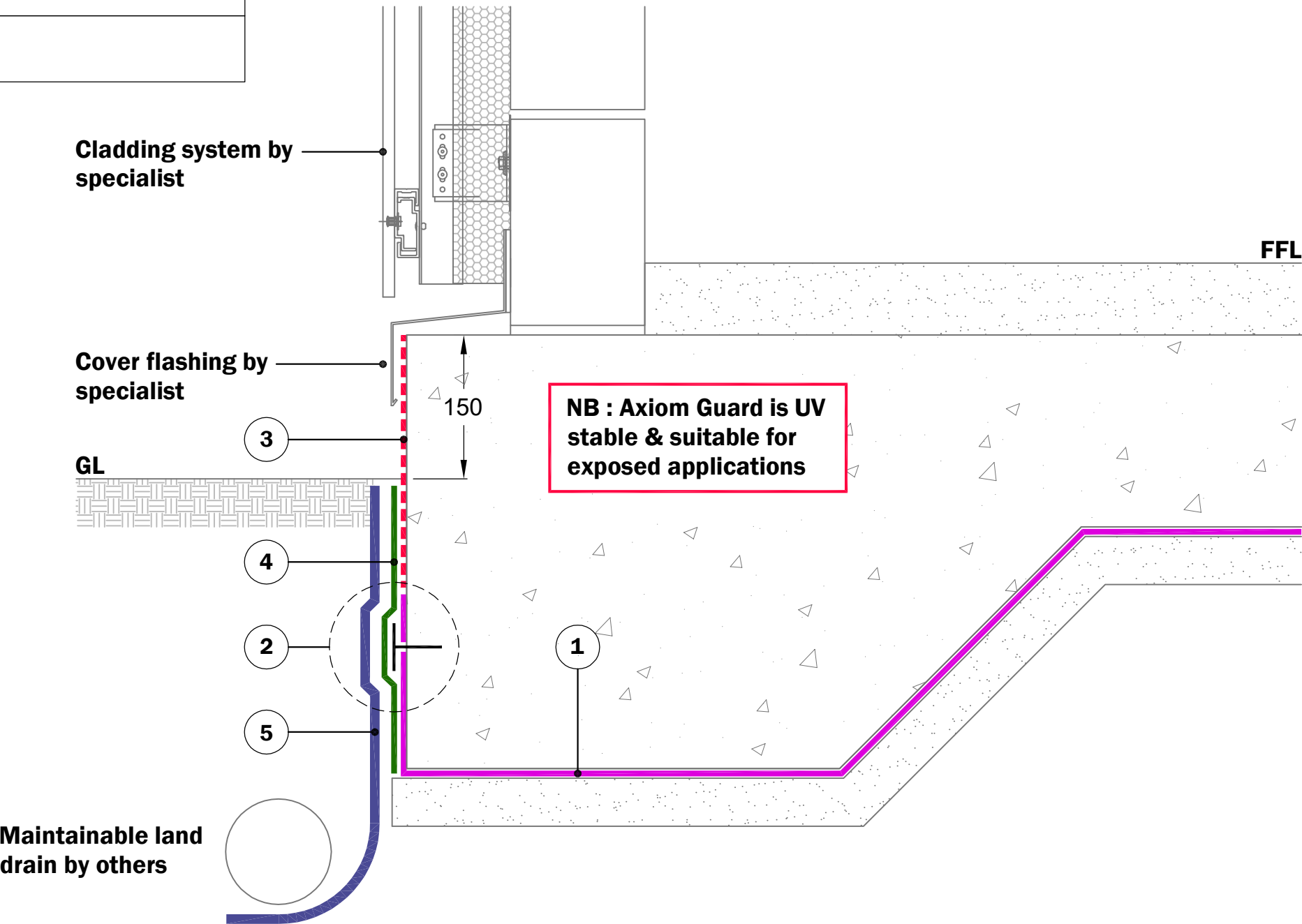

© Copyright reserved. This drawing may not be reproduced or amended without prior written permission.

Detail issued for Guidance Only. Designer's Approval Required.

Site construction sequencing should be assessed before the appropriate Visqueen Standard Detail is selected & approved by the Designer.

In order to develop a robust design for protecting a structure against groundwater, a Risk Assessment must be carried out in line with the guidance given in BS8102:2009.

The Designer may need to specify one or a combination of waterproofing measures.

All Visqueen materials must be installed in strict accordance with the manufacturer's instructions. Refer to the current Visqueen datasheets.

Do Not Scale - Use Figured Dimensions Only.

Detail is subject to SE approval.

Standard Detail



www.visqueen.com

Scale : NTS

Date : April.2020

Drawing No : AX-13



Typical Perimeter Detail - UV Exposed Slab - Visqueen PAM.

VISQUEEN
0333 202 6800
www.visqueen.com
enquiries@visqueen.com