

**KEY TO MATERIALS :-**

1	Visqueen Ultimate HC BLOK.
2	Visqueen Ultimate Double Sided Tape.
3	Visqueen Ultimate Lap Tape.
4	Smooth slab or blinding layer.

**NB : Ensure careful placement of steel reinforcement to avoid damage to the DPM.**

**TAPED JOINT :  
LOW RISK of hydrostatic  
water pressure**

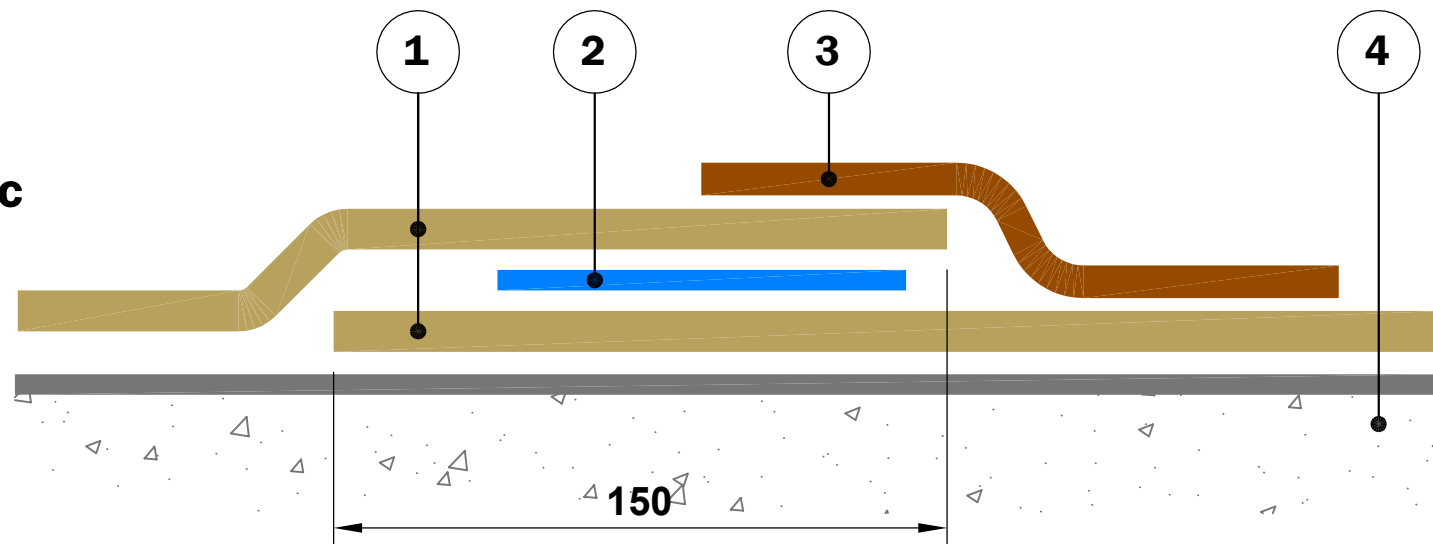

**FULLY WELDED JOINT :  
HIGH RISK of hydrostatic  
water pressure**

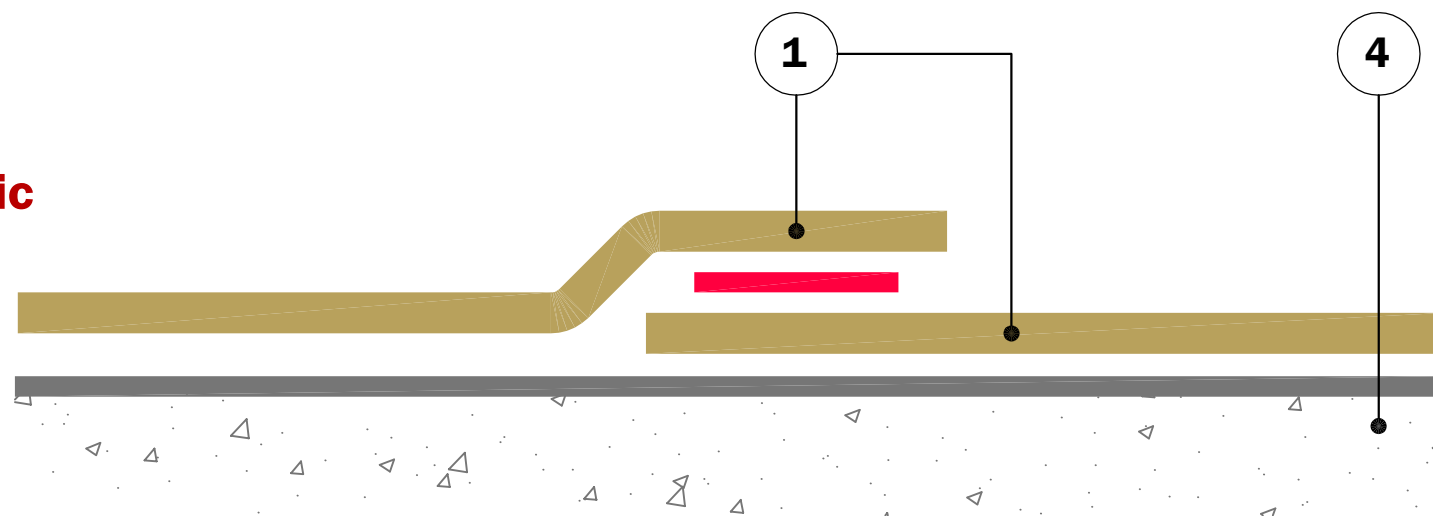

© Copyright reserved. This drawing may not be reproduced or amended without prior written permission.

Detail issued for Guidance Only. Designer's Approval Required.

Site construction sequencing should be assessed before the appropriate Visqueen Standard Detail is selected & approved by the Designer.

In order to develop a robust design for protecting a structure against groundwater, a Risk Assessment must be carried out in line with the guidance given in BS8102:2009.

The Designer may need to specify one or a combination of waterproofing measures.

All Visqueen materials must be installed in strict accordance with the manufacturer's instructions. Refer to the current Visqueen datasheets.

Do Not Scale - Use Figured Dimensions Only.

**Standard Detail**



[www.visqueen.com](http://www.visqueen.com)

Scale : NTS

Date : Oct.2019

Drawing No : HC-JD-01



**ULTIMATE**  
GAS MEMBRANES

**Typical Ultimate HC BLOK Jointing Details.**

**VISQUEEN**  
0333 202 6800  
[www.visqueen.com](http://www.visqueen.com)  
[enquiries@visqueen.com](mailto:enquiries@visqueen.com)