

**KEY TO MATERIALS :-**

1	Visqueen Radon R400 Membrane.
2	Visqueen 300mm / 500mm Detailing Strip.
3	Visqueen Double Sided Tape (10m x 50mm).

**Step 1.**

Install Visqueen Radon R400 Membrane on a suitable smooth & well compacted blinding layer. All laps to be 150mm minimum & fully sealed using Visqueen Double Sided Tape & Visqueen Pro Single Sided Lap Tape. Neatly cut the DPM around the profile of the steel column.

**Step 2.**

Ensure steelwork is clean & dry before applying Visqueen Detailing Strip (300mm or 500mm). Ensure that the Detailing Strip extends 150mm minimum horizontally onto the DPM & 150mm minimum vertically onto the steel column. Ensure all laps are fully sealed.

**Step 3.**

Apply more Detailing Strip to the remaining exposed steel flanges ensuring all laps are 150mm in all directions & fully sealed.

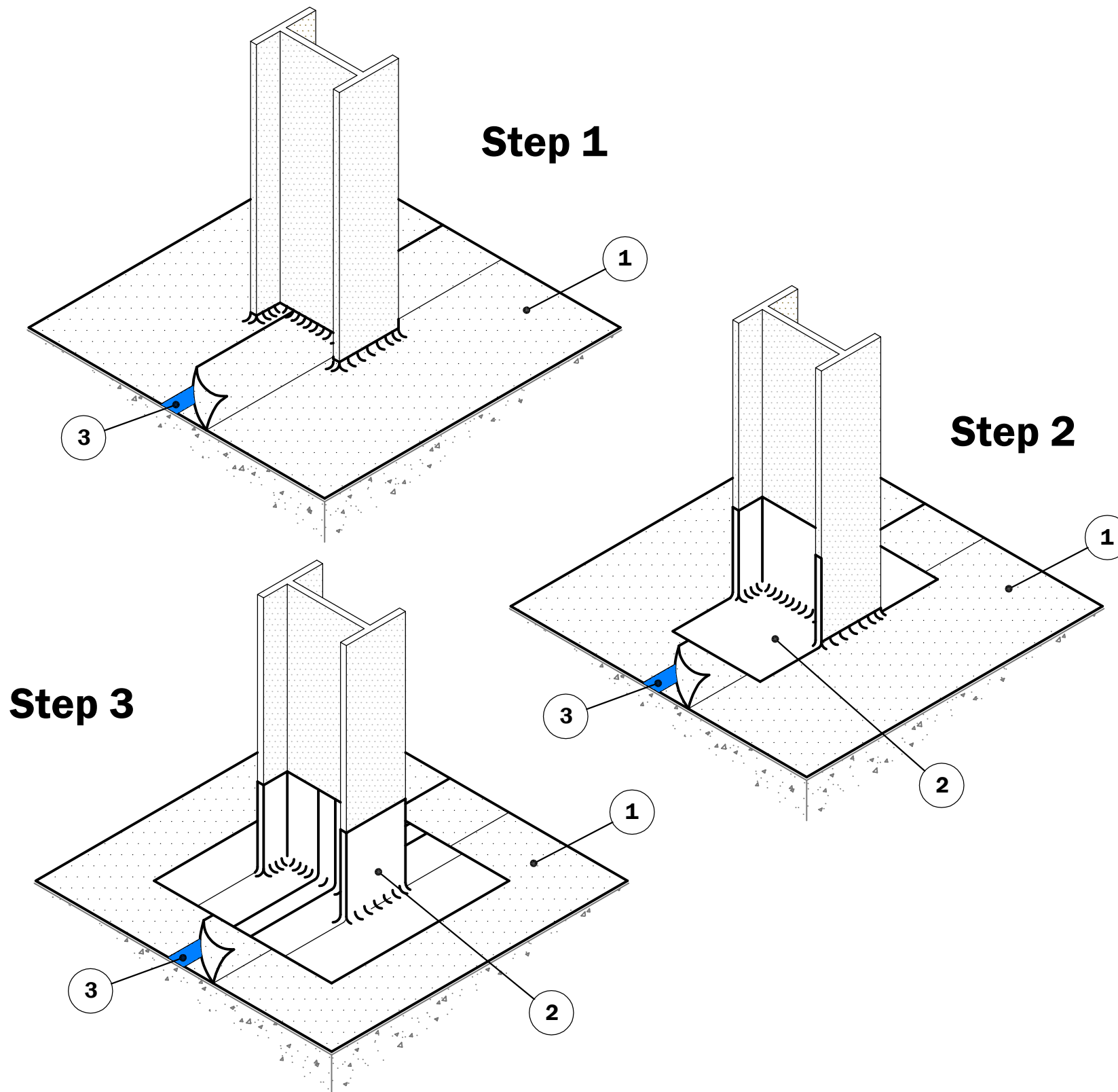

© Copyright reserved. This drawing may not be reproduced or amended without prior written permission.

Detail issued for Guidance Only. Designer's Approval Required.

Site construction sequencing should be assessed before the appropriate Visqueen Standard Detail is selected & approved by the Designer.

In order to develop a robust design for protecting a structure against groundwater, a Risk Assessment must be carried out in line with the guidance given in BS8102:2009.

The Designer may need to specify one or a combination of waterproofing measures.

All Visqueen materials must be installed in strict accordance with the manufacturer's instructions. Refer to the current Visqueen datasheets.

Do Not Scale - Use Figured Dimensions Only.

**Standard Detail**



[www.visqueen.com](http://www.visqueen.com)

Scale : NTS

Date : Dec.2018

Drawing No : RAD-52



**Typical Internal Steel Column Sealing Details (Slab Junctions Only).**

**VISQUEEN**  
 0333 202 6800  
[www.visqueen.com](http://www.visqueen.com)  
[enquiries@visqueen.com](mailto:enquiries@visqueen.com)